



DATA SHEET
miniature circuit-breakers
DMCB 2 Co80-3N
C characteristic
 Article number 09915083



Function

The task of miniature circuit breakers is to automatically disconnect circuits in order to protect lines and connected devices. After disconnection, they can be manually reactivated without the fuse sets having to be replaced, for example. Each of our miniature circuit breakers is equipped with a trip-free mechanism, which guarantees safe deactivation even if, for example, a switching knob is mechanically blocked. Miniature circuit-breakers of series DMCB 2 have a high rated short-circuit current of up to 25 kA. Large U-clamp terminals allow for the use of large conductor cross-sections. The switching mechanism is designed as a double circuit-breaker and has disconnecter properties thanks to a large contact gap. Switches with tripping characteristic C are optimised for power circuits with high inrush or peak currents.

Features

available in different rated currents, high short-circuit switching capacity, double-sided U-clamp terminals for large conductor cross-section and busbar, switch position indicator

Mounting

quick fastening to mounting rail, any installation position

Applications

suitable for use in power supplies for industrial facilities and purpose-built buildings or buildings for commercial use

Accessories

auxiliary switches DMCB 2 Hi, operating current trip DMCB 2 ASA

Technical Data

Technical Data	DMCB 2 Co80-3N
Series	DMCB 2
Number of poles	3+N
Tripping characteristic	C
Adjustment range of overload tripping	1.13 ... 1.45
Adjustment range of short-circuit tripping	5 ... 10
Reference temperature thermal release	40 °C
	load circuit
Specification	load disconnect contact
Rated voltage (AC)	230 V, 400 V
Rated voltage (DC)	120 V
Rated current (AC)	80 A
Rated current range I _n	63 - 125 A
Rated short-circuit current	20 kA
Rated insulation voltage	440 V
Rated impulse withstand voltage	4 kV

Subject to technical changes

Technical Data	DMCB 2 Co80-3N
Rated frequency	50 Hz, 60 Hz
Current heat loss per current path	5.53 W
Short-circuit backup-fuse SCPD	200 A
Back-up fuse type	gL
Oversvoltage class	III
	lift terminal, captive top and bottom (load circuit)
Protection against direct contact	DGUV V3, ÖVE-EN 6, finger and back-of-hand proof
Clamping area	2.5 mm ² ... 50 mm ²
Connection C1 Maximum number of conductors per terminal	(conductors of same type and cross-section)
Cross section solid	1-wire: 2 mm ² ... 50 mm ²
Tightening torque	2.5 Nm ... 3 Nm
	General data
Operating position	optional
Mechanical endurance	min. 20000 switching cycles
Storage temperature	-25 °C ... 55 °C
Ambient temperature	-25 °C ... 50 °C
Climate resistance	damp/heat: constant as per IEC 68-2-3, cyclical as per IEC 68-2-30
Housing type	distribution board housing
Installation type	Mounting rail (35 mm)
Housing material	thermoplastic
Protection class	IP20
sealable	true
Width	108 mm
Height	90 mm
Depth	71.5 mm
Installation depth	70 mm
Module widths	6
Weight	0.858 kg
Design requirements/Standards	EN 60947-2
Power limitation category	3
Degree of pollution	2

Dimensions

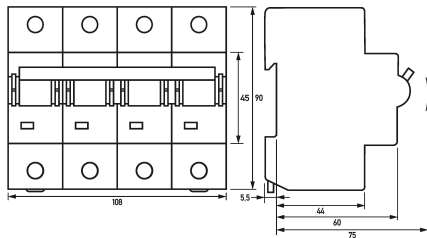

Dimensional drawing Group view

Wiring example



Wiring diagram

Subject to technical changes