



symbolic image

DATA SHEET

EDS 2E ohne LF 1

for daylight-linked lighting control (mounting rail installation)

Article number 09500126



[Internetlink](#)

Function

Twilight switches are switches that switch on electrical consumers when the daylight level drops below a lower light value and switches off the electrical consumers again when an upper light value is exceeded. Doepke twilight switches are available in designs for outdoor mounting and also for distribution board installation with light sensors mounted outdoors. The twilight switches of this series are devices for distribution board installation with an external light sensor. It is possible to install the switch and external light sensor anywhere, regardless of the lighting to be switched; the distribution board easily handles the settings for the switch-on/switch-off thresholds. The operating and control voltage of the devices is 230 V AC. The EDS 2E is a twilight switch that makes it possible to set the thresholds for the switch-on and switch-off brightness independently from one another. The brightness value for the switch-off in the morning can be set to a value lower than the value for the switch-on in the evening. This means that the switching hysteresis (switch-on threshold/switch-off threshold) is lower than 1. The advantage over twilight switches with a fixed switching hysteresis is that the lighting can be switched off at an earlier time in the morning and therefore significantly more energy can be saved. As the human eye adjusts to lower brightness values at night, this earlier switch-off is not bothersome.

Features

energy saving thanks to automatic lighting control, switch-on/switch-off delay mutes brief fluctuations in brightness, low internal consumption, easy mounting and adjustment, separately adjustable switch-on and switch-off threshold of 0.1 to 1000 lux, operating voltage 230 V AC, potential-free NO relay (16 A), switch-on/relay status indicated by LED, LF 1 light sensors for outdoor mounting (IP44), cable length to LF 1 up to 100 m, more than one twilight switch can use one LF 1.

Mounting

Twilight switch: quick fastening to mounting rail, any installation position
 Light sensor LF 1: , Wall mounting, preferably facing north or east

Applications

Control of lighting for streets, buildings and industrial premises.

Notes

Depending on the order number, the twilight switch is supplied with or without a light sensor.

Accessories

Sensors LF

Technical Data

Technical Data	EDS 2E ohne LF 1
Series	EDS 2E
Number of (n.o, n.c.,change-over)	1
Manual operating mode possible	false
Adjustability, delay	fixed
Switch-on delay range	max. 60 s
Switch-off delay range	max. 40 s
Hysteresis textual	adjustable
Adjustability, switch-on threshold twilight	Smooth, logarithmic

Technical Data	EDS 2E ohne LF 1
Switch-on threshold range shading twilight	0.1 lux ... 1000 lux
Adjustability of twilight hysteresis	Smooth
Twilight switch-off threshold range shading	0.1 lux ... 1000 lux
Operating voltage (AC)	230 V (207 V ... 253 V)
Operating frequency	50 Hz
Internal consumption	max. 1.6 W
	Display Power-on threshold, Output state
Type	LED
	Load circuit
Specification	Relay
Rated voltage (AC)	230 V
Rated current (AC)	16 A
Rated power	max. 3680 VA
Rated frequency	50 Hz
max. Output O1 rated power glow lamps	3000 VA
max. Output O1 Rated power fluorescent lamp compensated	200 VA
max. Output O1 Rated power fluorescent lamp not compensated	1000 VA
max. Output O1 rated power fluorescent lamps duo-switching	1000 VA
	Screw-type terminal (Sensor input)
Connection cable	100 m
Clamping area	0.4 mm ² ... 2.5 mm ²
Tightening torque	max. 0.6 Nm
	Screw-type terminal (Load output)
Clamping area	0.4 mm ² ... 2.5 mm ²
Tightening torque	max. 0.6 Nm
General data description	General data
Duty cycle	continuous operation (Duty cycle ≤ 100 %, at U _e)
Operating position	any
Ambient temperature	-10 °C ... 45 °C
Housing type	Distributor housing
Mounting type	Mounting rail
Housing material	Polycarbonate (PC)
Protection class	IP20
sealable	false
Width	35 mm
Height	85 mm
Depth	65 mm
Installation depth	58 mm
Width (modules)	2
Design requirements/Standards	EN 60669-1

Dimensions

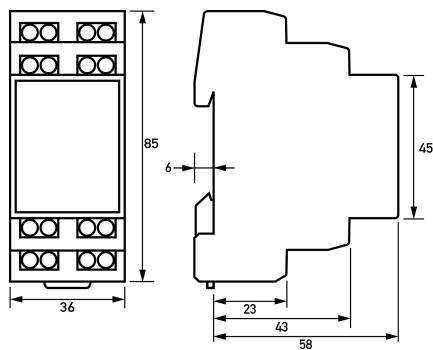

Dimensional drawing Group view

Wiring example

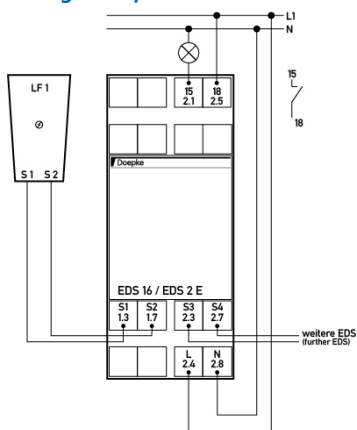

Wiring diagram