



symbolic image

DATA SHEET

DWP 140

pulsating AC/DC-sensitive type A

Article number 09340114



[Internetlink](#)



Function

Residual current transformers in combination with evaluation units are suitable for the protection or monitoring of electrical circuits. The transformers have a large selection of opening cross-sections (rated currents). For this reason it is possible to protect and monitor electrical systems with large conductor cross-sections, i.e. with high currents and high voltages. Transformers from series DWP combine with the DRP evaluation unit to form a modular residual current device (MRCD) as per VDE 0660-101. Residual current transformers with characteristic A detect sinusoidal AC currents as well as pulsating DC residual currents. The transformer covers all of the active conductors leading to the consumers and uses its output signal to illustrate the time curve of the sum of all conductor currents flowing through it. Its output signal is proportional to the residual current, which flows back to the earthing point of the supply mains via the protective earth conductor in the case of an insulation fault or via the earth.

Features

suitable for detecting type A and AC residual currents as well as pulsating DC residual currents, tightly stacked through-holes allow good adjustment to the cable to be monitored, label field with transparent cover, terminals up to 4 mm²

Mounting

The devices are mounted on stable substrata using the supplied mounting brackets.any installation position

Applications

Transformers from series MFIW are used in combination with series MFR modular residual current devices.

Notes

The through-hole should be filled as much as possible with the cable to be monitored, so that it is centred in the transformer. Faulty tripping caused by the transformer being asymmetrical can therefore be avoided.

Technical Data

Technical Data	DWP 140
Series	DWP 140
Current transformer specification	Differenzstromwandler
Current transformer suitable for	DRP
Residual current detection characteristic	A, AC
	Transformer primary
Rated voltage (AC)	0 V ... 690 V
rated impulse withstand voltage	8 kV / Kategorie IV
Rated current	350 A
Rated frequency	50 Hz ... 60 Hz
	Transformer secondary
Rated current strength secondary	2 A
	Screw-type terminal (Transformer output)
Protective cover available	true
Connection cable	10 m (e. g. LiY 0.5 mm ²)

Technical Data	DWP 140
max. Connector C1 Outer diameter Connection cable	93 mm
Clamping area	max. 4 mm ²
Tightening torque	max. 0.6 Nm
General data description	General data
Operating position	any
max. Operating altitude above MSL	2000 m
Storage temperature	-40 °C ... 85 °C
Ambient temperature	-25 °C ... 65 °C
Housing type	wall-mounted housing
Mounting type	Wall mounting
Housing material	Polycarbonate (PC)
Protection class	IP20
sealable	true
Width	33 mm
Height	220 mm
Depth	196 mm
Width with lugs	45 mm
Height with lugs	220 mm
Depth with lugs	196 mm
Installation depth	196 mm
Inside diameter	140 mm
Design requirements/Standards	VDE 0660-101 Part M, VDE 0662

Dimensions

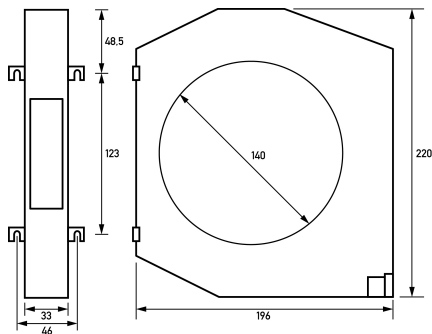

Dimensional drawing Group view