



symbolic image

DATA SHEET
interfaces
DRCCB 5 CM-M
for remotely monitoring the DRCCB 5
Article number 09200060



[Internetlink](#)



Function

In this context, interfaces are devices that enable communication between different components. They mainly use standardised hardware and protocol layers, such as RS485 and modbus. Devices in this series make it possible to connect third-party systems to residual current circuit-breakers from the DRCCB 5 series. They allow available switch information to be visualised and selected functions to be controlled. In this design, the devices offer a RS-485 interface with the "Modbus I RTU" protocol. Thanks to the physical design, it is possible to operate up to 99 modules in one network. It is possible to communicate with many visualisation systems thanks to the modbus protocol used.

Features

Modbus I RTU protocol via RS-485 interface, provides access to the circuit-breaker's status display (on/off/triggered) and further information, Performs the self-test function with recording, Configuration of the potential-free contact, Up to 99 interfaces possible in one network, low dissipation power of just 1 W

Mounting

mounting by clamping to the right of the basic device

Applications

Remote monitoring of power supplies to residential and purpose-built buildings as well as industrial facilities such as agricultural operations, Remote stations with electrical consumers, Wind power stations, Pumping stations, Water treatment plants, Telecommunication systems, Radio and transmission equipment, Solar power plants

Technical Data

Technical Data	DRCCB 5 CM-M
Series	DRCCB 5 CM
suitable for	DRCCB 5
	serial interface (RS 485)
Serial IF IF1 Protocols	Modbus I-RTU
Serial IF IF1 Transmission rate	38400 bit/s
Operating voltage (AC)	230 V (195.5 V ... 253 V)
Operating frequency	50 Hz
Rated impulse withstand voltage	4 kV
	screw-type terminal top and bottom (serial interface)
Clamping area	max. 2.5 mm ²
Tightening torque	max. 0.4 Nm
	General data
Ambient temperature	-25 °C ... 60 °C
Housing type	distribution board housing
Mounting type	Mounting rail (35 mm)
Width	29.9 mm
Height	116 mm
Depth	79 mm

Technical Data	DRCCB 5 CM-M
Installation depth	73 mm
Width (modules)	1

Dimensions

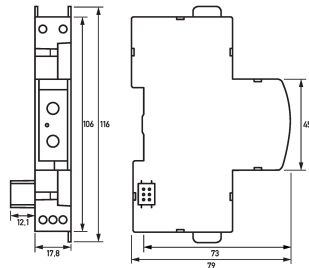

Wiring example

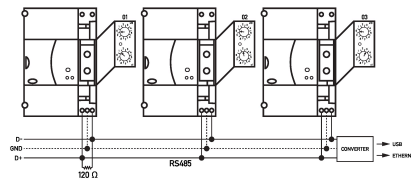

Wiring diagram

Dimensional drawing Group view