

Accessories

automatic reclosing devices DFA, terminal caps KA, information stickers HAS, auxiliary switches DHi, restart locks DFS WES, software DBS

Technical Data

Technical Data	DFS 4 100-4/0,30-B SK NA
Series	DFS 4 B SK NA
Number of poles	4
Residual current type	B
Tripping characteristic curve	SK
Rated current (AC)	100 A
Rated residual current I Δ n	0.3 A
Short-time delayed	true
Selective	false
min. Operating voltage range of test circuit	200 V
max. Operating voltage range of test circuit	440 V
Minimum rated operating voltage (Type A/AC operation)	0 V AC
Minimum rated operating voltage (Type B operation)	50 V AC
Non-trip time	10 ms
Tripping frequency	0 Hz ... 150 kHz
Maximum disconnection times	1 · I Δ n: \leq 300 ms; 5 · I Δ n: \leq 40 ms
Internal consumption	max. 2.2 W
	auxiliary device (Emergency shut-off device)
Additional device AE1 operating voltage	50 V ... 440 V (AC)
Auxiliary device AE1 Voltage of the monitoring circuit	12 V (DC)
Auxiliary device AE1 Voltage of the monitoring circuit	max. 1 mA (DC)
max. Auxiliary device AE1 Cable length of the monitoring circuit	500 m
	load circuit
Specification	load disconnect contact
min. Contact opening	4 mm
Rated voltage (AC)	230 V, 400 V
Rated current (AC)	100 A
Rated short-circuit current	10 kA
Surge current strength	3 kA
max. Total rated switching capacity	1000 A
Rated insulation voltage	400 V
Rated impulse withstand voltage	4 kV
Rated frequency	50 Hz
Current heat loss per current path	7.5 W
Thermal Backup-fuse OCPD	80 A
Short-circuit backup-fuse SCPD	125 A
Back-up fuse type	gG
	Auxiliary switch (additional emergency shut-off device)

Subject to technical changes

Technical Data	DFS 4 100-4/0,30-B SK NA
Specification	switching contact
Number of poles (total)	1
Contact assignment	1 CO
Rated voltage (AC)	12 V ... 230 V
Rated voltage (DC)	12 V ... 110 V
Rated impulse withstand voltage	4 kV
	screw-type terminal top and bottom (load circuit)
Neutral conductor position	left
Protection against direct contact	DGUV V3, VDE 0660-514, finger and back-of-hand proof
Connection C1 Maximum number of conductors per terminal	2 (conductors of same type and cross-section)
Cross section solid	1-wire: 1.5 mm ² ... 50 mm ² ; 2-wire: 1.5 mm ² ... 16 mm ²
Connecting capacity flexible	1-wire: 1.5 mm ² ... 50 mm ² ; 2-wire: 1.5 mm ² ... 16 mm ²
Cross section stranded	1-wire: 1.5 mm ² ... 50 mm ² ; 2-wire: 1.5 mm ² ... 16 mm ²
Cross section AWG, solid	15 ... 1
Cross section AWG, stranded	15 ... 1
Cross section AWG, flexible	15 ... 1
Cross section AWG, flexible with ferrule	15 ... 1
Tightening torque	2.5 Nm ... 3 Nm
	screw-type terminal top and bottom (Emergency shut-off device, auxiliary switches)
Allowed types of wires	solid conductor, flexible conductor, stranded conductors with ferrule
Connection C2 Maximum number of conductors per terminal	2 (conductors of same type and cross-section)
Cross section solid	1-wire: 1 mm ² ... 1.5 mm ² ; 2-wire: 1 mm ² ... 1.5 mm ²
Cross section flexible with ferrule	1 mm ² ... 1.5 mm ²
Cross section stranded	1-wire: 1 mm ² ... 1.5 mm ² ; 2-wire: 1 mm ² ... 1.5 mm ²
Cross section AWG, solid	17 ... 16
Cross section AWG, stranded	17 ... 16
Cross section AWG, flexible with ferrule	17 ... 16
Tightening torque	max. 0.8 Nm
	General data
Operating position	optional
max. Operating altitude above MSL	2000 m
Mechanical endurance	min. 5000 cycles
Electrical endurance	min. 2000 cycles
Surrounding atmosphere	normal environmental conditions
Storage temperature	-35 °C ... 75 °C
Ambient temperature	-25 °C ... 40 °C
Climate resistance	according to IEC 60068-2-30: humid heat / cyclic (25 °C / 55 °C; 93 % / 97 % RH)
Shock resistance	20 g / 20 ms Duration
Fatigue limit	> 5 g (f ≤ 80 Hz, duration > 30 min.)
Housing type	distribution board housing
Installation type	Mounting rail (35 mm)
Housing material	thermoplastic
Protection class	IP20 (installed: IP40)
sealable	true

Subject to technical changes

Technical Data	DFS 4 100-4/0,30-B SK NA
Width	81 mm
Height	85 mm
Depth	75 mm
Installation depth	69 mm
Module widths	4.5
Weight	0.532 kg
Design requirements/Standards	VDE 0664-10, VDE 0664-40, ÖVE/ÖNORM E 8601, DIN EN 61008-1, EN 62423
Degree of pollution	2

Dimensions

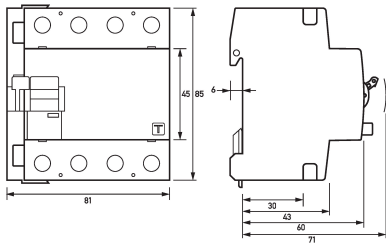

Dimensional drawing Group view

Wiring example

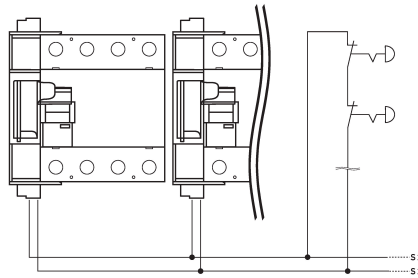

Diagrams

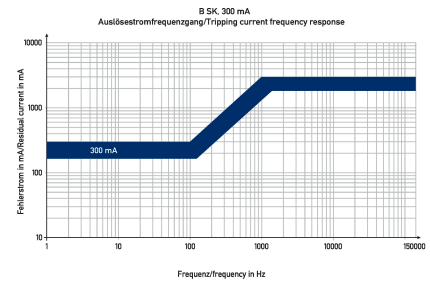

Characteristic B SK 300 mA

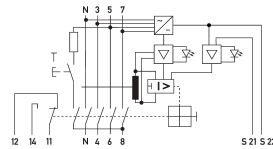

Wiring diagram

Wiring diagram additional file