



**DATA SHEET**  
**residual current circuit-breaker**  
**DFS 4 100-4/0,10-F**  
**sensitive to residual currents Type F**  
 Article number 09165820



**Function**

Residual current circuit-breakers (RCCBs) are components for implementing protective measure "Automatic disconnection of the power supply" as per VDE 0100 part 410 or corresponding international installation regulations. Series DFS 4 devices are compact two or four-pole residual current circuit-breakers. In the standard design, they only take up four module width units of space. Although DFS 4 devices for AC and pulsating DC residual currents are actually designed for three-phase networks, they can also be used in single-phase networks. However, in addition to these, special variants are also available for single or three-phase operation in the form of the AC/DC sensitive designs (type B, type B+). In spite of the compact dimensions, a number of different tripping currents and characteristics are available at rated currents, depending on the design, up to 125 A. They also have large two-tier terminals for large conductor cross-sections, a practical multi-functional switch toggle and can be provided with labels using free-of-charge software. Switches for residual current type F are mains voltage-independent and record type A sinusoidal alternating and pulsating DC residual currents as well as residual currents with mixed frequencies that differ from 50 Hz. For example, these can arise when using single-phase frequency converters. Devices in the standard design are intended for monitoring circuits with a rated voltage of 230 V, 400 V and a rated frequency of 50 Hz.

**Features**

sensitive to AC residual currents and pulsating DC residual currents at the mains frequency (type A) as well as AC residual currents with multiple frequency components not equal to 50 Hz, high immunity against surge currents and mains-voltage-operated secondary current impulses, compact design for all rated currents, high short-circuit resistance, double-sided two-tier terminals for large conductor cross-section and busbar, switch position indicator, viewing window for labels, multifunction switch toggle with three positions: "on", "off" and "tripped", Neutral conductor position left

**Mounting**

quick fastening to mounting rail, any installation position, supply from any direction

**Applications**

Modern domestic installations with LED lighting systems and single-phase frequency converters, Ideal for systems where RCCBs Type A have a tendency towards faulty trips due to surge residual currents, Commercial and industrial installations with TN-S, TT- and TN-C-S systems, where power electronics equipment is used without galvanic isolation from the mains, e.g. switching power supplies, high-frequency converters, photovoltaic installations and UPS equipment with frequency converters without transformers, Not permitted for use in TN-C networks; not permitted for protecting systems in which electronic equipment could generate smooth DC currents. Comprehensive protection is not provided in this case. For these applications we recommend our AC/DC sensitive residual current circuit-breakers (Type B or B+).

**Notes**

suitable for use in 50 Hz AC networks, Not designed for use in direct current networks or on the output side of controlled electrical equipment such as frequency converters.

**Accessories**

automatic reclosing devices DFA, terminal caps KA, information stickers HAS, auxiliary switches DHi, restart locks DFS WES, software DBS

**Technical Data**

Technical Data	DFS 4 100-4/0,10-F
Series	DFS 4 F
Number of poles	4
Residual current type	F

Subject to technical changes

Technical Data	DFS 4 100-4/0,10-F
Rated current (AC)	100 A
Rated residual current I $\Delta$ n	0.1 A
Short-time delayed	true
Selective	false
min. Operating voltage range of test circuit	200 V
max. Operating voltage range of test circuit	440 V
Non-trip time	10 ms
Maximum disconnection times	1 · I $\Delta$ n: ≤ 300 ms; 5 · I $\Delta$ n: ≤ 40 ms
<b>load circuit</b>	
Specification	load disconnect contact
min. Contact opening	4 mm
Rated voltage (AC)	230 V, 400 V
Rated current (AC)	100 A
Rated short-circuit current	10 kA
Surge current strength	3 kA
max. total rated switching capacity	1000 A
Rated insulation voltage	400 V
Rated impulse withstand voltage	4 kV
Rated frequency	50 Hz
Current heat loss per current path	7.5 W
thermal Backup-fuse OCPD	80 A
short-circuit backup-fuse SCPD	125 A
Back-up fuse type	gG
<b>screw-type terminal top and bottom (load circuit)</b>	
Neutral conductor position	left
Protection against direct contact	DGUV V3, VDE 0660-514, finger and back-of-hand proof
Connection C1 Maximum number of conductors per terminal	2 (conductors of same type and cross-section)
Cross section solid	1-wire: 1.5 mm <sup>2</sup> ... 50 mm <sup>2</sup> ; 2-wire: 1.5 mm <sup>2</sup> ... 16 mm <sup>2</sup>
Connecting capacity flexible	1-wire: 1.5 mm <sup>2</sup> ... 50 mm <sup>2</sup> ; 2-wire: 1.5 mm <sup>2</sup> ... 16 mm <sup>2</sup>
Cross section stranded	1-wire: 1.5 mm <sup>2</sup> ... 50 mm <sup>2</sup> ; 2-wire: 1.5 mm <sup>2</sup> ... 16 mm <sup>2</sup>
Cross section AWG, solid	15 ... 1
Cross section AWG, stranded	15 ... 1
Cross section AWG, flexible	15 ... 1
Cross section AWG, flexible with ferrule	15 ... 1
Tightening torque	2.5 Nm ... 3 Nm
<b>General data</b>	
Operating position	optional
max. Operating altitude above MSL	2000 m
Mechanical endurance	min. 5000 cycles
Electrical endurance	min. 2000 cycles
Surrounding atmosphere	normal environmental conditions
Storage temperature	-35 °C ... 75 °C
Ambient temperature	-25 °C ... 40 °C

Subject to technical changes

Technical Data	DFS 4 100-4/0,10-F
Climate resistance	according to IEC 60068-2-30: humid heat / cyclic (25 °C / 55 °C; 93 % / 97 % RH)
Shock resistance	20 g / 20 ms Duration
Fatigue limit	> 5 g (f ≤ 80 Hz, duration > 30 min.)
Housing type	distribution board housing
Installation type	Mounting rail (35 mm)
Housing material	thermoplastic
Protection class	IP20 (installed: IP40)
sealable	true
Width	72 mm
Height	85 mm
Depth	75 mm
Installation depth	69 mm
Module widths	4
Design requirements/Standards	VDE 0664-10, DIN EN 61008-1, ÖVE/ÖNORM E 8601
Degree of pollution according to EN 60664	2
Certifications	VDE

**Dimensions**

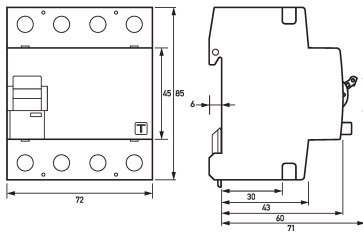

Dimensional drawing Group view

**Wiring example**

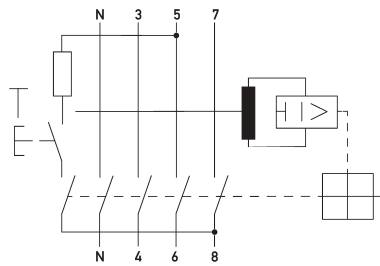

Wiring diagram