

AC/DC sensitive type B, selective, Rated voltage 290 V, 500 V

suitable for use in 50 Hz AC networks, RCCBs for other frequencies available upon request, Not designed for use in direct current networks or on the output side of controlled electrical equipment such as frequency converters. , To ensure the selectivity of the RCCB, the rated residual current of the selective RCCB must be set at least one level higher than the downstream instantaneous switch.

Accessories

automatic reclosing devices DFA, terminal caps KA, information stickers HAS, auxiliary switches DHi, restart locks DFS WES, software DBS

Technical data

Series	DFS 4 B SK S V
Number of poles	4
Residual current type	B
Tripping characteristic curve	SK
Rated current (AC)	80 A
Rated residual current $I_{\Delta n}$	0.5 A
Short-time delayed	false
Selective	true
min. Operating voltage range of test circuit	200 V
max. Operating voltage range of test circuit	550 V
Minimum rated operating voltage (Type A/AC operation)	0 V AC
Minimum rated operating voltage (Type B operation)	50 V AC
Non-trip time	50 ms
Tripping frequency	0 Hz ... 150 kHz
Maximum disconnection times	1 · $I_{\Delta n}$: ≤ 500 ms; 5 · $I_{\Delta n}$: ≤ 150 ms
Response delay	1 · $I_{\Delta n}$: 130 ms < $T \leq 500$ ms; 5 · $I_{\Delta n}$: 50 ms < $T \leq 150$ ms
Internal consumption	max. 2.2 W
	load circuit
Specification	load disconnect contact
min. Contact opening	4 mm
Rated voltage (AC)	290 V, 500 V
Rated current (AC)	80 A
Rated short-circuit current	10 kA
Surge current strength	5 kA
max. Total rated switching capacity	800 A
Rated insulation voltage	500 V
Rated impulse withstand voltage	4 kV
Rated frequency	50 Hz
Current heat loss per current path	5 W
Thermal Backup-fuse OCPD	80 A
Short-circuit backup-fuse SCPD	125 A
Back-up fuse type	gG
I^2t strength	48 kA ² s
Dynamic current strength I_p	6 kA
	screw-type terminal top and bottom (load circuit)
Neutral conductor position	left
Protection against direct contact	DGUV V3, VDE 0660-514, finger and back-of-hand proof
Connection C1 Maximum number of conductors per terminal	2 (conductors of same type and cross-section)
Cross section solid	1-wire: 1.5 mm ² ... 50 mm ² ; 2-wire: 1.5 mm ² ... 16 mm ²
Connecting capacity flexible	1-wire: 1.5 mm ² ... 50 mm ² ; 2-wire: 1.5 mm ² ... 16 mm ²
Cross section stranded	1-wire: 1.5 mm ² ... 50 mm ² ; 2-wire: 1.5 mm ² ... 16 mm ²
Cross section AWG, solid	15 ... 1
Cross section AWG, stranded	15 ... 1
Cross section AWG, flexible	15 ... 1
Cross section AWG, flexible with ferrule	15 ... 1
Tightening torque	2.5 Nm ... 3 Nm
	General data
Operating position	optional
max. Operating altitude above MSL	2000 m
Mechanical endurance	min. 5000 cycles
Electrical endurance	min. 2000 cycles
Surrounding atmosphere	normal environmental conditions
Storage temperature	-40 °C ... 70 °C
Ambient temperature	-25 °C ... 40 °C
Climate resistance	according to IEC 60068-2-30: humid heat / cyclic (25 °C / 55 °C; 93 % / 97 % RH)
Shock resistance	20 g / 20 ms Duration
Fatigue limit	> 5 g (f ≤ 80 Hz, duration > 30 min.)
Housing type	distribution board housing
Installation type	Mounting rail (35 mm)
Housing material	thermoplastic
Protection class	IP20 (installed: IP40)

sealable	true
Width	72 mm
Height	85 mm
Depth	75 mm
Installation depth	69 mm
Module widths	4
Weight	0.506 kg
Design requirements/Standards	VDE 0664-10, VDE 0664-40, ÖVE/ÖNORM E 8601, DIN EN 61008-1, EN 62423
Degree of pollution	2

Dimensions

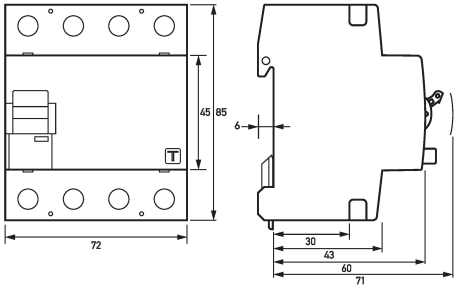

Dimensioned drawing residual current circuit-breaker DFS 4 080-4/0,50-B SK S V500

Wiring example

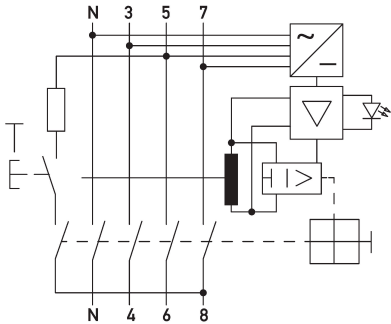

Wiring example residual current circuit-breaker DFS 4 080-4/0,50-B SK S V500

Diagrams

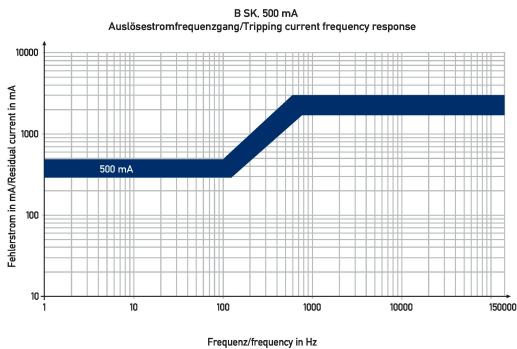

Diagrams residual current circuit-breaker DFS 4 080-4/0,50-B SK S V500