



DATA SHEET

residual current circuit-breaker

DFS 4 063-4/0,03-AC FT

sensitive to residual currents Type AC, with remote-tripping function

Article number 09144922



Function

Residual current circuit-breakers (RCCBs) are components for implementing protective measure "Automatic disconnection of the power supply" as per VDE 0100 part 410 or corresponding international installation regulations. Series DFS 4 devices are compact two or four-pole residual current circuit-breakers. In the standard design, they only take up four module width units of space. Although DFS 4 devices for AC and pulsating DC residual currents are actually designed for three-phase networks, they can also be used in single-phase networks. However, in addition to these, special variants are also available for single or three-phase operation in the form of the AC/DC sensitive designs (type B, type B+). In spite of the compact dimensions, a number of different tripping currents and characteristics are available at rated currents, depending on the design, up to 125 A. They also have large two-tier terminals for large conductor cross-sections, a practical multi-functional switch toggle and can be provided with labels using free-of-charge software. Switches with residual current characteristic AC only detect AC residual currents. They cannot detect pulsating DC residual currents so are not permitted for use as residual current operated protective devices in Germany. They are therefore only available as export models. With the FT design, the connections of the internal test key are wired to two terminals, so that the test device can be activated externally. An auxiliary contact also signals disconnection of the circuit-breaker. Devices in the standard design are intended for monitoring circuits with a rated voltage of 230 V, 400 V and a rated frequency of 50 Hz.

Features

help function integrated, pin assignment 1 break contact/1 changeover contact , tripping not dependent on mains and auxiliary voltage, sensitive to AC residual currents (type AC) , compact design for all rated currents, high short-circuit resistance, double-sided two-tier terminals for large conductor cross-section and busbar, switch position indicator, viewing window for labels, multifunction switch toggle with three positions: "on", "off" and "tripped" , Neutral conductor position left

Mounting

quick fastening to mounting rail, any installation position, supply from any direction

Applications

Power supplies to residential and purpose-built buildings as well as industrial facilities with TN-S, TT and TN-C-S networks. In IT networks, the residual current circuit-breakers of this series can be set to switch off in the event of a second fault, RCCBs from the FT series are especially suitable for the remote switch-off of systems and parts of systems and for being tripped by hazard alarms, amongst other devices, Not permitted for use in TN-C networks; not permitted for protecting systems in which electronic equipment may cause pulsating or smooth DC residual currents or residual currents with frequencies not equal to 50 Hz. Comprehensive protection is not provided with an RCCB type AC. For these applications we recommend our residual current circuit-breaker type A or our AC/DC sensitive residual current circuit-breaker type B/B+.

Notes

Devices for FT variants must not be used in emergency-stop positions. The type-A and type-B NA variants are available for this purpose, The contacts of the external command device must be designed for a rated residual current ≥ 0.5 A and for the rated voltage of the residual current circuit-breaker.

Accessories

terminal caps KA, information stickers HAS, restart locks DFS WES, software DBS

Technical Data

Technical Data	DFS 4 063-4/0,03-AC FT
Series	DFS 4 AC FT
Number of poles	4
Residual current type	AC

Technical Data	DFS 4 063-4/0,03-AC FT
Rated current (AC)	63 A
Rated residual current $I_{\Delta n}$	0.03 A
Short-time delayed	false
Selective	false
min. Operating voltage range of test circuit	250 V
max. Operating voltage range of test circuit	440 V
Maximum disconnection times	$1 \cdot I_{\Delta n} \leq 300 \text{ ms}; 5 \cdot I_{\Delta n} \leq 40 \text{ ms}$
	control input
Galvanically separated	false
Rated voltage (AC)	400 V
	load circuit
Specification	load disconnect contact
min. Contact opening	4 mm
Rated voltage (AC)	230 V, 400 V
Rated current (AC)	63 A
Rated short-circuit current	10 kA
Surge current strength	0.25 kA
max. Total rated switching capacity	800 A
Rated insulation voltage	400 V
Rated impulse withstand voltage	4 kV
Rated frequency	50 Hz
Current heat loss per current path	3.1 W
Thermal Backup-fuse OCPD	63 A
Short-circuit backup-fuse SCPD	100 A
Back-up fuse type	gG
	remote trip
Specification	switching contact
Number of poles (total)	1
Contact assignment	1 NC
Rated voltage (AC)	12 V ... 230 V
Rated voltage (DC)	12 V ... 110 V
Tolerance of rated voltage	max. 5 %
Rated current (AC)	6 A
Rated current (DC)	1 A
	screw-type terminal top and bottom (load circuit)
Neutral conductor position	left
Protection against direct contact	DGUV V3, VDE 0660-514, finger and back-of-hand proof
Connection C1 Maximum number of conductors per terminal	2 (conductors of same type and cross-section)
Cross section solid	1-wire: 1.5 mm ² ... 50 mm ² ; 2-wire: 1.5 mm ² ... 16 mm ²
Connecting capacity flexible	1-wire: 1.5 mm ² ... 50 mm ² ; 2-wire: 1.5 mm ² ... 16 mm ²
Cross section stranded	1-wire: 1.5 mm ² ... 50 mm ² ; 2-wire: 1.5 mm ² ... 16 mm ²
Cross section AWG, solid	15 ... 1
Cross section AWG, stranded	15 ... 1
Cross section AWG, flexible	15 ... 1

Subject to technical changes

Technical Data	DFS 4 063-4/0,03-AC FT
Cross section AWG, flexible with ferrule	15 ... 1
Tightening torque	2.5 Nm ... 3 Nm
	screw-type terminal top, bottom (remote trip)
Protection against direct contact	DGUV V3, VDE 0660-514, finger and back-of-hand proof
Connection C2 Maximum number of conductors per terminal	2 (conductors of same type and cross-section)
Cross section solid	1-wire: 1 mm ² ... 1.5 mm ² ; 2-wire: 1 mm ² ... 1.5 mm ²
Cross section flexible with ferrule	1 mm ² ... 1.5 mm ²
Cross section stranded	1-wire: 1 mm ² ... 1.5 mm ² ; 2-wire: 1 mm ² ... 1.5 mm ²
Cross section AWG, solid	17 ... 16
Cross section AWG, stranded	17 ... 16
Cross section AWG, flexible with ferrule	17 ... 16
Tightening torque	max. 0.8 Nm
	General data
Operating position	optional
max. Operating altitude above MSL	2000 m
Mechanical endurance	min. 5000 cycles
Electrical endurance	min. 2000 cycles
Surrounding atmosphere	normal environmental conditions
Storage temperature	-35 °C ... 75 °C
Ambient temperature	-25 °C ... 40 °C
Climate resistance	according to IEC 60068-2-30: humid heat / cyclic (25 °C / 55 °C; 93 % / 97 % RH)
Shock resistance	20 g / 20 ms Duration
Fatigue limit	> 5 g (f ≤ 80 Hz, duration > 30 min.)
Housing type	distribution board housing
Installation type	Mounting rail (35 mm)
Housing material	thermoplastic
Protection class	IP20 (installed: IP40)
sealable	true
Width	81 mm
Height	85 mm
Depth	75 mm
Installation depth	69 mm
Module widths	4.5
Weight	0.474 kg
Design requirements/Standards	VDE 0664-10, DIN EN 61008-1
Degree of pollution	2

Dimensions

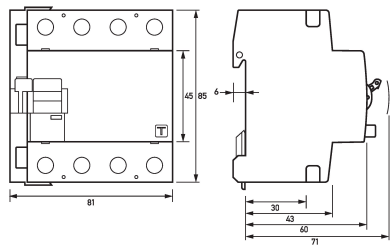

Dimensional drawing Group view

Wiring example

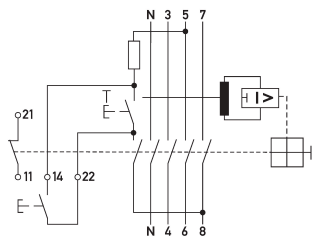

Wiring diagram