



symbolic image

## DATA SHEET

residual current circuit-breaker

**DFS 4 040-4/0,03-F Audio**

sensitive to residual currents Type F, Low-impedance design for audio systems

Article number 09134846



[Internetlink](#)



### Function

Series DFS 4 devices are compact two or four-pole residual current circuit-breakers. In the standard design, they only take up four module width units of space. Although DFS 4 devices for AC and pulsating DC residual currents are actually designed for three-phase networks, they can also be used in single-phase networks. However, in addition to these, special variants are also available for single or three-phase operation in the form of the AC/DC sensitive designs (type B, type B+). In spite of the compact dimensions, a number of different tripping currents and characteristics are available at rated currents, depending on the design, up to 125 A. They also have large two-tier terminals for large conductor cross-sections, a practical multi-functional switch toggle and can be provided with labels using free-of-charge software.

### Accessories

automatic reclosing devices DFA, terminal caps KA, information stickers HAS, auxiliary switches DHi, restart locks WES, software DBS

### Technical Data

Technical Data	DFS 4 040-4/0,03-F Audio
Series	DFS 4 F Audio
Rated residual current $I_{\Delta n}$	0.03 A
Short-time delayed	true
Selective	false
min. Operating voltage range of test circuit	250 V
max. Operating voltage range of test circuit	440 V
Non-trip time	10 ms
Maximum disconnection times	$1 \cdot I_{\Delta n}: \leq 300 \text{ ms}; 5 \cdot I_{\Delta n}: \leq 40 \text{ ms}$
Supply side	up, down
Short-time delayed	true
Short-time delayed	true
Number of (n.o, n.c., change-over)	4
Number of (n.o, n.c., change-over)	4
Number of poles	4
Number of poles (total)	4
contact assignment	4 NO
contact assignment	4 NO
contact assignment	4 NO
Rated voltage (AC)	230 V, 400 V
Surge current strength	3 kA

Technical Data	DFS 4 040-4/0,03-F Audio
max. total rated switching capacity	500 A
Rated frequency	50 Hz
Current heat loss per current path	1.3 W
thermal Backup-fuse OCPD	40 A
short-circuit backup-fuse SCPD	100 A
Neutral conductor position	left
	General data
Surrounding atmosphere	normal environmental conditions
Width	72 mm
Depth	75 mm
Installation depth	69 mm
Module widths	4

**Dimensions**

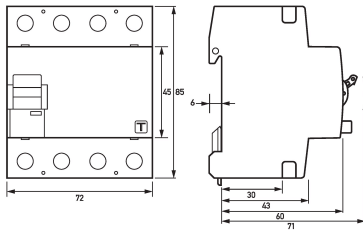

*Dimensional drawing Group view*

*STEP file*

**Wiring example**

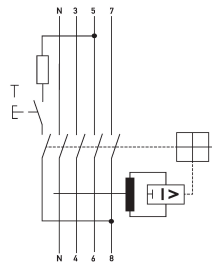

*Wiring diagram*