



## DATA SHEET

### residual current circuit-breaker

#### DFS 4 025-4/0,03-B+ R HD

AC/DC sensitive type B+, fire protection according to VDE 0100-420, for harsh environments

Article number 09124896HD



#### Function

Residual current circuit-breakers (RCCBs) are components for implementing protective measure "Automatic disconnection of the power supply" as per VDE 0100 part 410 or corresponding international installation regulations. Series DFS 4 devices are compact two or four-pole residual current circuit-breakers. In the standard design, they only take up four module width units of space. Although DFS 4 devices for AC and pulsating DC residual currents are actually designed for three-phase networks, they can also be used in single-phase networks. However, in addition to these, special variants are also available for single or three-phase operation in the form of the AC/DC sensitive designs (type B, type B+). In spite of the compact dimensions, a number of different tripping currents and characteristics are available at rated currents, depending on the design, up to 125 A. They also have large two-tier terminals for large conductor cross-sections, a practical multi-functional switch toggle and can be provided with labels using free-of-charge software. Switches with residual current characteristic B+ detect smooth DC residual currents as well as all other type B+ residual currents as per DIN VDE 0664-400. The operating voltage required for this is taken from the mains supply. Correct power supply is ensured when the voltage between the mains conductors is  $\geq 50$  V. Type A residual currents are detected regardless of the mains voltage. They also seamlessly detect residual currents in all frequencies up to 20 kHz with a maximum tripping threshold of 420 mA. Devices with characteristic B+ therefore provide better fire protection, i.e. they provide fire protection even when residual currents with frequencies above the rated frequency occur. Protection as per VDE 0100 part 410 is provided with a corresponding earth resistance via the entire frequency range of residual current detection. The maximum permissible earth resistance is calculated as the quotient from the permissible touch voltage and the maximum trip residual current in the entire detected frequency range. Devices in the standard design are intended for monitoring circuits with a rated voltage of 230 V, 400 V and a rated frequency of 50 Hz. With an airtight, encapsulated tripping mechanism from a special alloy and the stainless steel latch, residual current circuit-breakers in HD design are protected, in particular from corrosion, corrosive gases, moisture and extreme temperature fluctuations.

#### Features

AC/DC sensitive for residual currents with frequencies and mixed frequencies of 0 Hz (smooth direct current) up to 20 kHz, Fire protection as per VDE 0100-420, mains-voltage-independent tripping when type A residual currents occur, voltage-dependent detection of smooth DC and AC residual currents with frequencies not equal to 50 Hz, full functionality with mains voltages from at least 50 V AC on any two active conductors, compact design for all rated currents, high short-circuit resistance, double-sided two-tier terminals for large conductor cross-section and busbar, switch position indicator, viewing window for labels, multifunction switch toggle with three positions: "on", "off" and "tripped", Neutral conductor position right

#### Mounting

quick fastening to mounting rail, any installation position, supply preferably from above

#### Applications

Commercial and industrial installations with TT, TN-S and TN-C-S systems, where power electronics equipment is used without galvanic isolation from the mains, e.g. frequency converters, switching power supplies, high-frequency converters, photovoltaic installations and UPS equipment with frequency converters without transformers, Facilities at risk of fire

#### Notes

suitable for use in 50 Hz AC networks, RCCBs for other frequencies available upon request, Not designed for use in direct current networks or on the output side of controlled electrical equipment such as frequency converters.

#### Accessories

automatic reclosing devices DFA, terminal caps KA, information stickers HAS, auxiliary switches DHi, restart locks DFS WES, software DBS

**Technical Data**

| Technical Data  | DFS 4 025-4/0,03-B+ R HD  |
|---|---|
| Series  | DFS 4 B+ HD   |
| Number of poles   | 4   |
| Residual current type                                   | B+  |
| Rated current (AC)                                      | 25 A  |
| Rated residual current $I_{\Delta n}$                   | 0.03 A  |
| Short-time delayed                                      | true  |
| Selective   | false   |
| min. Operating voltage range of test circuit            | 150 V   |
| max. Operating voltage range of test circuit            | 250 V   |
| Minimum rated operating voltage (Type A/AC operation)   | 0 V AC  |
| Minimum rated operating voltage (Type B operation)      | 50 V AC   |
| Non-trip time   | 10 ms   |
| Tripping frequency                                      | 0 Hz ... 20 kHz   |
| Maximum disconnection times                             | $1 \cdot I_{\Delta n}: \leq 300 \text{ ms}; 5 \cdot I_{\Delta n}: \leq 40 \text{ ms}$                   |
| Internal consumption                                    | max. 2.2 W  |
|   | <b>load circuit</b>   |
| Specification   | load disconnect contact   |
| min. Contact opening                                    | 4 mm  |
| Rated voltage (AC)                                      | 230 V, 400 V  |
| Rated current (AC)                                      | 25 A  |
| Rated short-circuit current                             | 10 kA   |
| Surge current strength                                  | 3 kA  |
| max. Total rated switching capacity                     | 500 A   |
| Rated insulation voltage                                | 400 V   |
| Rated impulse withstand voltage                         | 4 kV  |
| Rated frequency   | 50 Hz   |
| Current heat loss per current path                      | 0.5 W   |
| Thermal Backup-fuse OCPD                                | 25 A  |
| Short-circuit backup-fuse SCPD                          | 100 A   |
| Back-up fuse type                                       | gG  |
|   | <b>screw-type terminal top and bottom (load circuit)</b>  |
| Neutral conductor position                              | right   |
| Protection against direct contact                       | DGUV V3, VDE 0660-514, finger and back-of-hand proof  |
| Connection C1 Maximum number of conductors per terminal | 2 (conductors of same type and cross-section)   |
| Cross section solid                                     | 1-wire: 1.5 mm <sup>2</sup> ... 50 mm <sup>2</sup> ; 2-wire: 1.5 mm <sup>2</sup> ... 16 mm <sup>2</sup> |
| Connecting capacity flexible                            | 1-wire: 1.5 mm <sup>2</sup> ... 50 mm <sup>2</sup> ; 2-wire: 1.5 mm <sup>2</sup> ... 16 mm <sup>2</sup> |
| Cross section stranded                                  | 1-wire: 1.5 mm <sup>2</sup> ... 50 mm <sup>2</sup> ; 2-wire: 1.5 mm <sup>2</sup> ... 16 mm <sup>2</sup> |
| Cross section AWG, solid                                | 15 ... 1  |
| Cross section AWG, stranded                             | 15 ... 1  |
| Cross section AWG, flexible                             | 15 ... 1  |
| Cross section AWG, flexible with ferrule                | 15 ... 1  |

Subject to technical changes

| Technical Data                    |  | DFS 4 025-4/0,03-B+ R HD   |
|-----------------------------------|--|--|
| Tightening torque                 |  | 2.5 Nm ... 3 Nm  |
|                                   |  | General data   |
| Operating position                |  | optional   |
| max. Operating altitude above MSL |  | 2000 m   |
| Mechanical endurance              |  | min. 5000 cycles   |
| Electrical endurance              |  | min. 2000 cycles   |
| Surrounding atmosphere            |  | harsh environmental conditions   |
| Storage temperature               |  | -35 °C ... 75 °C   |
| Ambient temperature               |  | -25 °C ... 60 °C   |
| Climate resistance                |  | according to IEC 60068-2-30: humid heat / cyclic (25 °C / 55 °C; 93 % / 97 % RH) |
| Shock resistance                  |  | 20 g / 20 ms Duration  |
| Fatigue limit                     |  | > 5 g (f ≤ 80 Hz, duration > 30 min.)  |
| Housing type                      |  | distribution board housing   |
| Installation type                 |  | Mounting rail (35 mm)  |
| Housing material                  |  | thermoplastic  |
| Protection class                  |  | IP20 (installed: IP40)   |
| sealable                          |  | true   |
| Width                             |  | 72 mm  |
| Height                            |  | 85 mm  |
| Depth                             |  | 75 mm  |
| Installation depth                |  | 69 mm  |
| Module widths                     |  | 4  |
| Weight                            |  | 0.485 kg   |
| Design requirements/Standards     |  | VDE 0664-10, VDE 0664-400, ÖVE/ÖNORM E 8601, DIN EN 61008-1                      |
| Degree of pollution               |  | 2  |
| Certifications                    |  | VDE  |

Dimensions

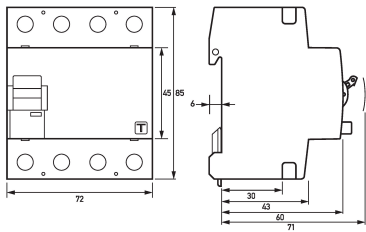

Dimensional drawing Group view

Wiring example

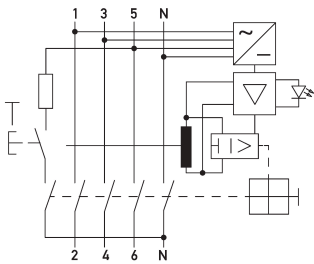

Wiring diagram

Diagrams

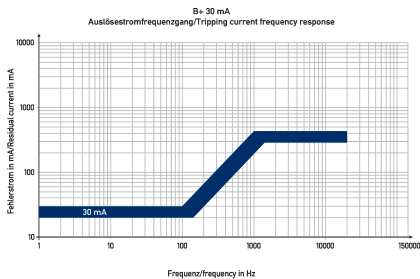

Characteristic B+ 30 mA